

# Instructions

# Panasonic

## Dome Cover

Model No. **WV-CF5S**

Before attempting to connect or operate this product, please read these instructions carefully and save this manual for future use.

## Features

The WV-CF5S is the smoke type dome cover dedicated to the Panasonic network camera WV-CF284.

## Installations

Please read the operating instructions for the camera as well.

1. Detach the enclosure from the camera.
  - ① Remove the dome cover fixing screw (M3, step screw).
  - ② Rotate the dome cover counter-clockwise.
2. Detach the dome cover and the inner dome from the camera.

Bend the enclosure to release the three stoppers on the enclosure one by one.

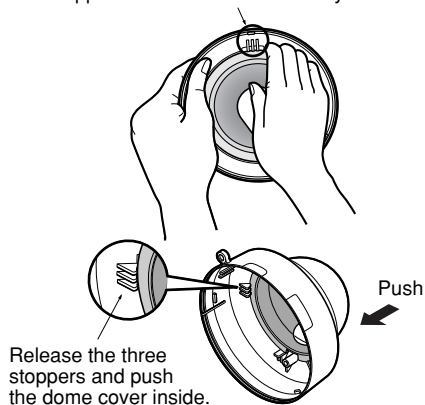
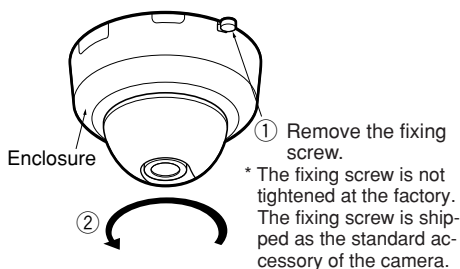

3. Replace the dome cover.
  - ① Attach the smoke type dome cover (this product) to the inner dome while matching the stopper of the inner dome and the notch of the smoke type dome cover.
  - ② Insert it into the enclosure and make sure that both the smoke type dome cover and the inner dome are stuck in with the stoppers on the enclosure.
  - ③ Rotate the attached dome cover to check if it rotates smoothly together with the inner dome.
4. Attach the enclosure to the main body of the camera.  
Refer to the operating instructions of the camera.

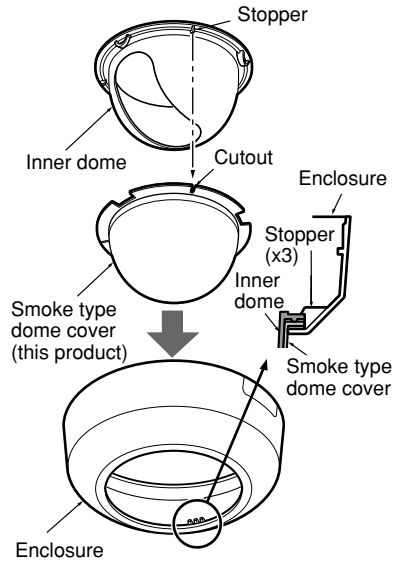

## Specifications

Ambient temperature	-10 °C to +50 °C
Weight	25 g {0.055 lbs.}
Dimensions	Diameter 92 mm {3-5/8"} (Dome diameter 80 mm {3-1/8"}) Height 49.5 mm {1-15/16"}

## Standard Accessories

Instructions (this document)..... 1 pc.

### For U.S., Canadian and Puerto Rican fields:

**Panasonic System Solutions Company,**  
Unit Company of Panasonic Corporation of North America

**Security Systems**  
[www.panasonic.com/security](http://www.panasonic.com/security)  
For customer support, call 1.877.733.3689

**Executive Office:** Three Panasonic Way 2H-2, Secaucus,  
New Jersey 07094

**Zone Office**  
**Eastern:** Three Panasonic Way, Secaucus, New Jersey 07094  
**Central:** 1707 N. Randal Road, Elgin, IL 60123  
**Southern:** 1225 Northbrook Parkway, Suwanee, GA 30024  
**Western:** 6550 Katella Ave., Cypress, CA 90630

**Panasonic Canada Inc.**  
5770 Ambler Drive, Mississauga,  
Ontario, L4W 2T3 Canada (905)624-5010  
<http://www.panasonic.ca>

**Panasonic Sales Company**  
Division of Panasonic Puerto Rico Inc.  
San Gabriel Industrial Park 65th Infantry Ave. KM. 9.5 Carolina  
P.R. 00985(809)750-4300

### For European and other fields:

**Matsushita Electric Industrial Co., Ltd.**

Osaka, Japan  
<http://panasonic.net>